

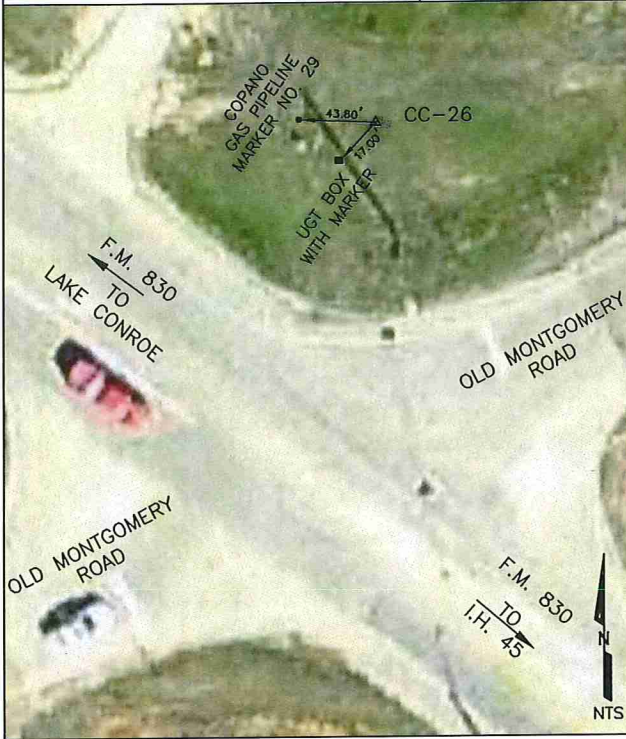

ENGINEERING
CITY OF CONROE

300 W. Davis P.O. Box 3066
Conroe, Texas 77305 (936) 522-3130



MARKER No.: CC-26_ADJ	COUNTY: MONTGOMERY
NORTHING	EASTING
GRID:10141628.07	GRID:3815075.31
SURFACE:10141629.56	SURFACE:3815074.68
SCALE FACTOR: 0.99993876	ELEVATION: 364.12
DATUMS: NAD83 (2011) CENTRAL/NAVD88-91	
DESCRIPTION: SET DISC IN CONCRETE ON NORTHWEST CORNER OF INTERSECTION OF F.M. 830 WITH OLD MONTGOMERY ROAD. (STAMPED CITY OF CONROE-CAPITAL PROJECTS CC-26)	
DATE ESTABLISHED: 03-16-2011 (ADJUSTED 07-23-14)	
BEARING TO CC-26 AZ_ADJ: S 0°37'43" E 994.70' SURFACE	



Benchmark No. 12

Rotated to

General Location: At the north corner of the intersection of Old Montgomery Road and FM 830

Latitude: 30° 23' 55.28976"
Longitude: 95° 30' 54.82947"
Grid Northing: 10,141,628.11
Grid Easting: 3,815,075.28
Surface Northing: 10,142,006.00
Surface Easting: 3,815,217.43

*CC-26 Ads
0.04x0.04*

Texas Coordinate System of 1983 (NAD83, CORS)
Central Zone (4203)

Elevation: 365.28 Project Datum

Mark Logo: City of Conroe Capital Projects
Designation: CC-26
Fnd 3" Aluminum Disk in Conc. Stamped "CC 26"

Project Datum is based on a call elevation of 212.00 at S.J.R.A. G.R.P. BM#5 being a 3" brass disk in conc. with a mark logo "City of Houston SJRA 1972" stamped "D-1 D-3" located at the Lake Conroe gauging station pier on the dam structure.

Combined Factor: 0.9999627395
Surface = Grid / Combined Factor
Units of Measure: U.S. Survey Foot

Detail Sketch:

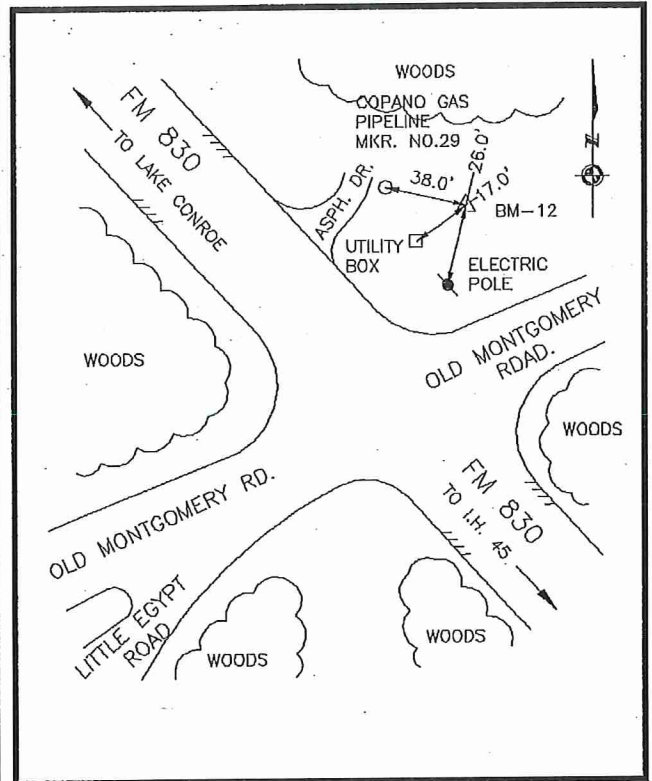

Photo 1-Station Detail:

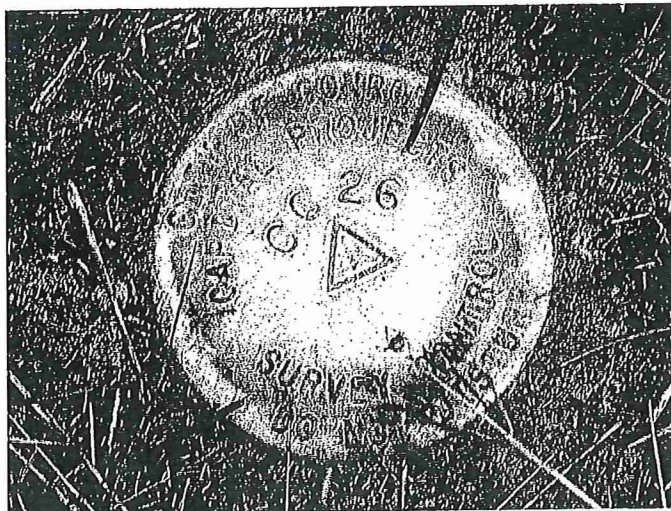

Photo 2-Station Area Picture:

